

## Standard Gain Horn Antenna

### WR42/17.6-26.7GHz/10dBi Typ, Gain

**Model: TL-42SHA10**

TL-42SHA10 is a standard gain horn antenna that operates from 17.6 GHz to 26.7 GHz. The antenna offers 10 dBi nominal gain. The input of this antenna is a WR42 waveguide with FBP220 anti-cocking flange. The standard gain horn is offered for antenna range calibration purpose mainly, but it can be also used for general purpose system set ups.

#### Features:

- Operating Frequency 17.6 to 26.7 GHz
- Gain: 10dBi Typ
- Good Impedance Match

#### Applications:

- Antenna Ranges
- Antenna Gain Measurements
- System Setups

### 电气特性 Electrical Characteristics:

参数 Parameter	Min	Typ	Max	单位 Units
频率范围 Frequency Range	17.6		26.7	GHz
增益 Gain		10		dBi
驻波 Input VSWR			1.2	:1

### 环境和机械特性 Environmental And Physical Characteristics:

类型 Description	参数 Parameter	单位 Units
材质 Material	Copper	
表面处理 Finish	Acid passivation, Spray black paint	
接口 Connectors	WR42	
尺寸 Size	45*24*17	mm

外形图 Outline Drawing:

Unit:mm

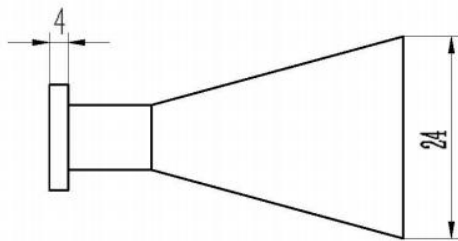
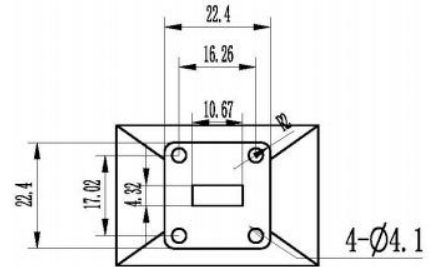
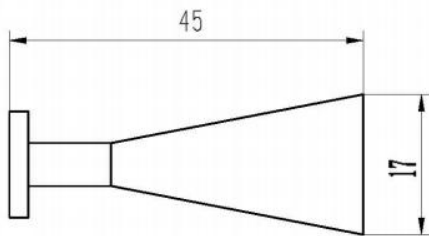

ESD Protection: Strictly adhere to ESD precautions to prevent electrostatic damage.

订货信息 Ordering Information:

标准型号 Base Number	描述 Description	版本号 Revision
TL-42SHA10	Standard Gain Horn Antenna, 17.6-26.7GHz, Gain: 10dBi Typ.	Rev.1.0