

Coaxial Fixed Attenuator

SMA Female/DC-12.4GHz

Model:TAXXA50-S-12.4C-F

TAXXA50-S-12.4C-F is a 10//20/30/40 dB coaxial attenuator that is used in millimeterwave systems and operates from DC to 12.4 GHz.

Features:

- Operating Frequency DC to 12.4GHz
- Broadband Coverage
- Lost Cost

Applications:

- Test Lab
- Instrumentations
- System Integration

Electrical Characteristics:

Parameter	Min	Typ	Max	Units
Frequency Range	DC		12.4	GHz
Attenuation Range		10 ±1.2		dB
		20±1.2		dB
		30±1.2		dB
		40±1.2		dB
VSWR			1.35	:1
Impedance		50		Ohms
RF Power Rating*	50 Watts Average at 25°C; Peak: 500W (5 μSec Pulse Width , 5% Duty Cycle)			

*Note: Average power linearly decreases to 10W when temperature rises to 125°C.

Envrionmental And Physical Characteristics:

Description	Parameter	Units
Operating Temperature	-65~+125	°C
Body Material	Anodized Aluminum	
Connector Material	Stainless Steel Passivation	
Inner Conductor	Gold-plated, Beryllium Bronze	
Connectors	SMA Female	
Size	88.9*67*93.2	mm
Weight	500	g

Outline Drawing:

Unit:mm

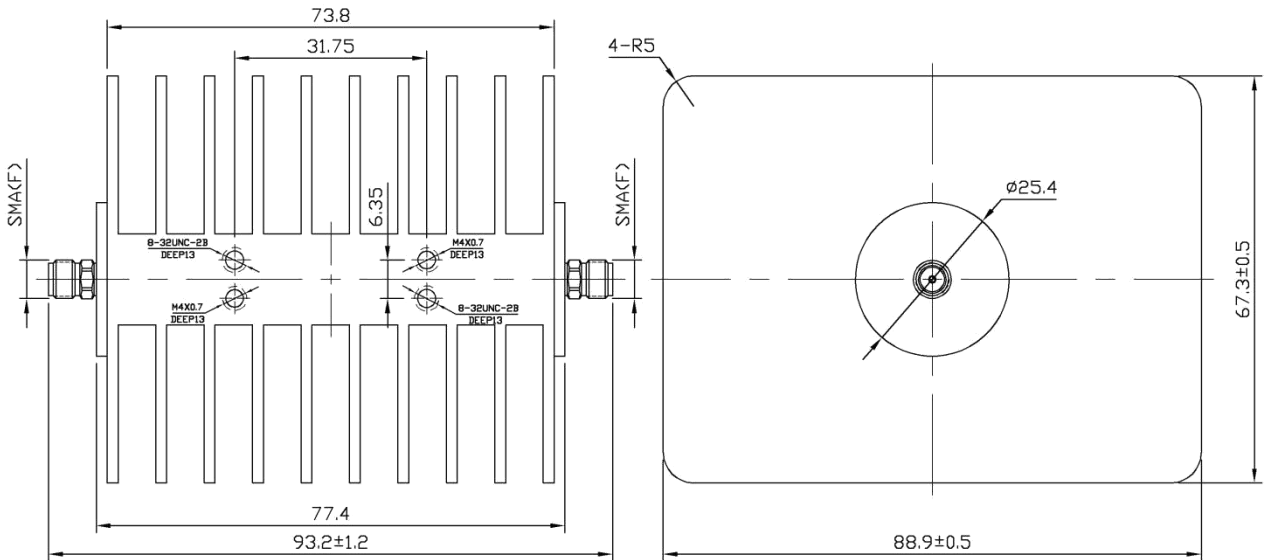

ESD Protection: Strictly adhere to ESD precautions to prevent electrostatic damage.

Ordering Information:

Base Number	Description
TA10A50-S-12.4C-F	Coaxial Fixed Attenuator, DC-12.4GHz, 10±1.2dB Attenuation
TA20A50-S-12.4C-F	Coaxial Fixed Attenuator, DC-12.4GHz, 20±1.2dB Attenuation
TA30A50-S-12.4C-F	Coaxial Fixed Attenuator, DC-12.4GHz, 30±1.2dB Attenuation
TA40A50-S-12.4C-F	Coaxial Fixed Attenuator, DC-12.4GHz, 40±1.2dB Attenuation